

Package Contents

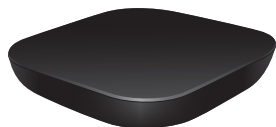

VBOX



Keyboard Remote Control
with Wireless Adapter



Batteries



Power Adapter



HDMI Cable



AV Cable



Ethernet Cable



Manual

Connecting the VBox to your TV

HDMI Connection

For the best picture quality, we recommend using the HDMI cable to connect the VBox to your TV.

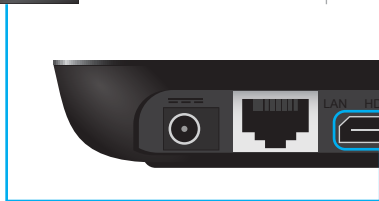

OR

AV Connection

If your TV doesn't have an HDMI input, you can also connect the VBox using the AV cable.

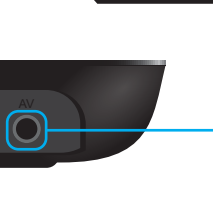

Power Up

Connect the Remote

In order for keyboard remote to work, make sure you insert the USB wireless adapter included in the package.

Open the rear panel of your remote control and install the 2 batteries included in your package.



Connect the Power Adapter

Connect the power adapter as indicated.

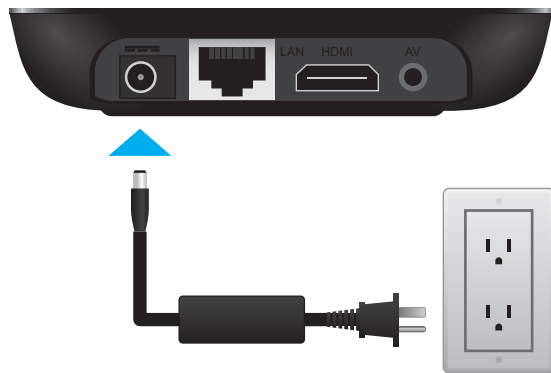

Network Setup

WiFi Connection

If you have a wireless router at home, you can connect your VBox wirelessly.

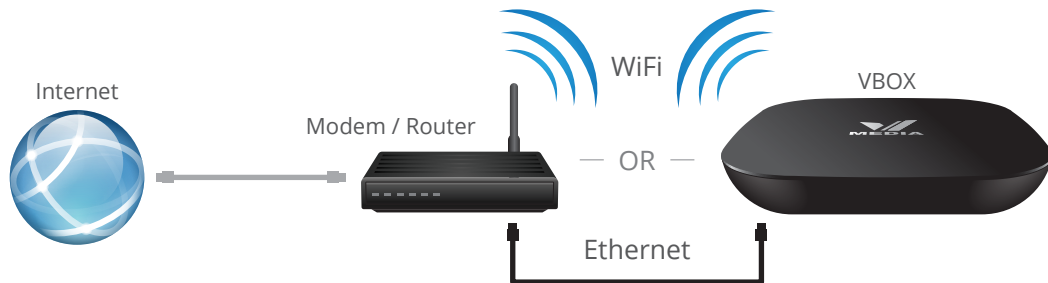

Ethernet Connection (Recommended)

Connecting to the internet with the Ethernet provides a more stable connection and avoids video buffering. You can locate your router closer to the TV or use a longer cable to connect the router to TV. Plug the Ethernet cable into the LAN port of your Modem/Router and into the VBOX.

Quick Setup



1

Welcome

Press OK on your remote.



2

Display Settings

Depending on the position of the blue dots on your screen, you may need to adjust your settings.



3

Internet Set-Up

Wi-Fi - Choose your network and enter your network password. Select Connect and press OK on your remote.

Ethernet - You will be automatically connected. Doesn't require additional settings in most cases.



4

VCloud TV Setup

You will see a series of screens describing VCloud TV and asking for your authorization to record selected channels on your behalf.

Using Your Remote

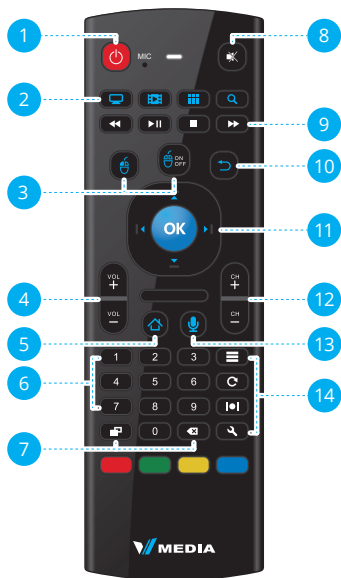

- 1 **Power**
- 2 **TV** - Opens TV Guide
Video - Opens VOD screen
Apps - Opens Apps screen
Search - Opens Search screen
- 3 **Pointer Click**
Mouse Pointer On/Off
- 4 **Vol** - Volume control
- 5 **Home** - Main Menu
- 6 Digital buttons used to select a channel number in TV Guide or to enter your username and password
- 7 **Display** - Shows, hides and switches different on-screen overlays
Backspace - Allows toggling between last viewed content
- 8 **Mute**
- 9 **Rewind, Play, Pause, Stop, Fast Forward**
- 10 **Back** - Back to previous menu/screen
- 11 **Navigation** - Move **Up, Down, Left and Right**
OK - Confirm selection
- 12 **Ch** - Channel selection
- 13 **Voice Activation**
- 14 **Search**
Refresh - Refresh screen information
Wide - Aspect ratio
Settings - Additional VBox settings

Main Menu



TV

Hundreds of TV channels, as well as TV channel apps from around the world.



Video

Movies for every taste, every interest and every language, VOD as well as Google Play, Netflix and YouTube.



Apps

Access all your favourite apps on the big screen.



Music

Tuneln, Songza, last.fm and more, as well as your own music, available on external hard drives or local network.



Photos

Access all your photos on your big screen, from your network and hard-drives, as well as through Picasa, Instagram and Google+.



Web

And for everything else, you can browse the web from the comfort of your couch.